

**Baba Beach Club Hua Hin** was envisioned with the intention of combining extraordinary experiences with barefoot elegance whilst presenting itself as a Music Lovers Hotel. The luxury beachfront property occupies 12 rais with a prime address between Cha Am & Hua Hin. With unrivalled beachfront access, opulent swimming pools, panoramic sea views & thrilling dining experiences, Baba Beach Club Hua Hin boasts a year-round resonance that attracts well-heeled guests spilling down from Bangkok at the weekends who pair with high-profile guests from around the world.

The newest addition to the luxury portfolio of accommodations is the Habita Seaview, a relic that nods to the splendour of the past and the magnificence of modern design. 12 stories high in the sky, it's home to 46 Suites and 1 Penthouse, all equipped with the best amenities, utmost privacy and unparalleled hospitality curated for connoisseurs of culture and style. From 63 sqm to 125 sqm, each unit boasts a terrace with spectacular views of the sea. The Penthouse takes up all 355 sqm of the topmost floor, presented as a refined living space with an infinity-edge pool.

## HOTEL FACILITIES & SERVICE

- 3 Restaurants & 3 Bars
- Beach Club
- Kid's Club
- In Room/Villa Dining
- Yaya Boutique
- Car Parking Area
- Beachfront Wedding & Event Space
- Beachfront Entertainment Pool
- Baba Fit (Gym)
- Steam Room
- Baan Chok Beachfront Café & Eatery
- Villa Assistant
- Private Luxury Car Transfer
- Garden Pool
- Cool Spa
- Beach Activities
- Reading Room
- 24hr Reception & Security
- Meeting & Large Function Venue

## SUITES & VILLAS

### Habita Seaview

- 20 Baba Ocean Suite (63 sq.m.)
- 10 Baba Ocean Corner Suite (90 sq.m.)
- 8 Baba Grand Ocean Suite (94 sq.m.)
- 8 Baba Grand Ocean Corner Suite (125 sq.m.)
- 1 Baba Mama Penthouse (355 sq.m.)

### Beachfront

- 6 Beachfront Club Garden Pool Suite (95 sq.m.)
- 10 Beachfront Club Pool Suite (73 sq.m.)
- 2 Beachfront Club Penthouse (150 sq.m.)

### Pool Villas

- Three Bedroom Pool Villa (252 sq.m.)
- Three Bedroom Luxury Pool Villa (493 sq.m.)
- Five Bedroom Luxury Pool Villa (918 sq.m.)

## SUITE & VILLA FEATURES

Private infinity-edge pool, private ocean-facing balcony, oversized bathtub, safety deposit box, in-suite/villa mini-bar, Nespresso coffee machine, snacks replenished daily, BOSE/JBL sound system and iPod with Baba Beach Club curated playlists, Wi-Fi, welcome tropical fruit basket





Baan Chok



Baba Beach Bar & Restaurant



Baba Soul Food

## BABA DINING

### Baba Beach Restaurant

Contemporary dining in a cool and casual beach restaurant offering a moreish selection of Asian and international favorites. Guests can enjoy a prime selection of meat and seafood prepared on a Josper Grill alongside a no-fuss menu of pasta, pizza, Japanese selections and thrilling local dishes that explore the taste and textures of Thailand.

### Baba Beach Bar

A beacon of cutting-edge style and design with an immersive entertainment area, infinity-edge pool and alfresco Baba Beach Bar serving sassy libations from where guests can quickly and conveniently whisk away to a pristine beach and plenty of restaurants.

### Baan Chok, Beachfront Café & Eatery

Transporting you to another era, Baan Chok is a two-storey beachfront abode that was designed in a neo-colonial architectural style. Looking out over a lush green garden and undisrupted beach views, the café lends an imperial essence to a beachfront experience that is elevated by an elegant procession of classic teas, stylish coffee, desserts and a charming menu of smaller bites.

### Baba Soul Food

A new all-day dining concept that serves modern eastern cuisine and classic western plates adapted for breakfast, lunch, dinner and all the small bites in between alongside a fragrant selection of home-cooked regional flavours that push the ambitions of Thai food.

### Baba Lounge

The Baba Lounge offers a new sophisticated approach to drinks in a centralized location serving palatable snacks in the company of bespoke cocktails, a selection of fine wine and artistic spirits in a resplendent setting. Ideal for pre and post-dinner drinks.

### Garden Pool Bar

Nestled on an open-air lawn bordered by lush manicured gardens, cabanas and a sundeck, the Pool Bar is where you can relish in the comforts of a true luxury holiday for the deserving soul. From here you can bask in the warm rays of the sun and dip your toes in an opulent 35-metre Garden Pool while grazing on light snacks and keeping cool with a creative cocktail from the swim-up bar.

## OUR SERVICES

### Cool Spa

Unwind and escape with a cossetting spa break at our swanky Cool Spa, offering a seductive spa journey with treatments ranging from traditional Thai and Swedish massages to aromatherapy elevated by a unique touch of Asian techniques.

### Beach Weddings & Event Space

Celebrate love starting with an ocean-facing ceremony while the sunset paints the water and finish with a twinkle-lit extravaganza under the stars. Borrowing its luxury colonial charm from Baan Chok, the 1,500-sqm alfresco courtyard garden was built for l'art de recevoir – or the art of entertaining – and can accommodate grand weddings ceremonies, fairytale receptions, musical performances, garden parties, corporate events and intimate affairs.

### Meetings & Function Venues

An ornate chandeliered ballroom dressed in a modern European elegance that's rounded out with a glam vibe. Glass doors that open to two terraces, glass-lid sunroofs and a garden atmosphere ensure plenty of natural light floods the whole room. The chateaux-like Ballroom – called the Baba Space – can be divided into two smaller ballrooms: Space 1 and Space 2 and can transform into a professional function space, whether it be a business meeting, a grand conference or a private party. Opulent and awe-inspiring, throw the big bash of your dreams.

### Location

Located in Thew Talay World on a private stretch of beach between Cha-am and Hua Hin, Baba Beach Club Hua Hin and the Habita Seaview are just a two-hour drive from Bangkok's Suvarnabhumi Airport and 15 minutes away from Hua Hin's downtown. Hua Hin has been recognized as one of the most popular beach destinations, featuring white sandy beaches and breathtaking views of the Gulf of Thailand.

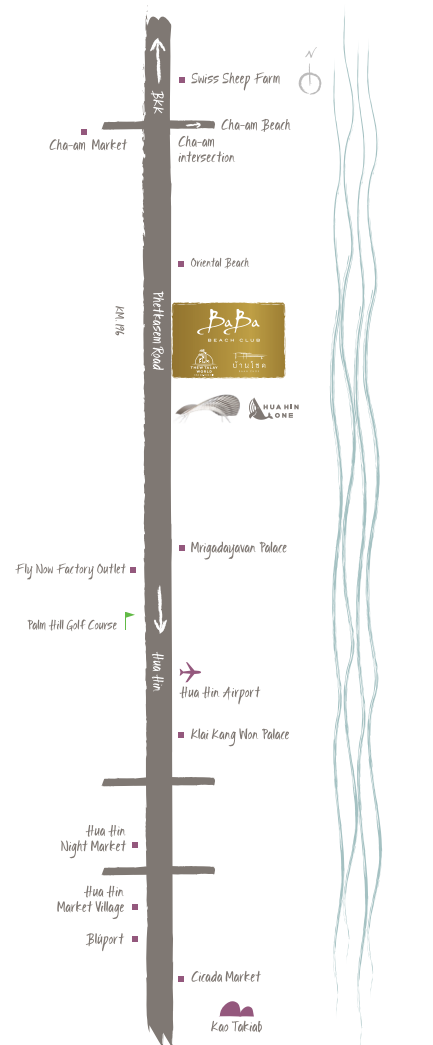





## MEETINGS & EVENTS

2,530 sq. m.	1,500 sq. m.	7	65   17
Total Event Space	Largest Room Setup	Function Venues	Guest Rooms & Pool Villas

### FEATURES

- Beachfront Function Space
- Flexible Layouts
- AV Equipment
- Stage (Installed/Portable)
- Chandeliered Ballroom
- Stand Up bar
- Digital Signage
- Microphone & Speaker Device
- Floor-to-Ceiling Glass Windows
- Divisible Rooms
- Projector
- Video Conferencing
- Natural Daylight
- Custom Menus
- Rear Screen Projection
- Video Surveillance

### MEETING SERVICE

- Complimentary Wi-Fi
- AV Technician
- Electrician

### CATERING

- Full & Half Day Meeting Package
- Refreshment Break
- Reception
- Breakfast / Lunch / Dinner





## FLOOR PLAN LEVEL 2

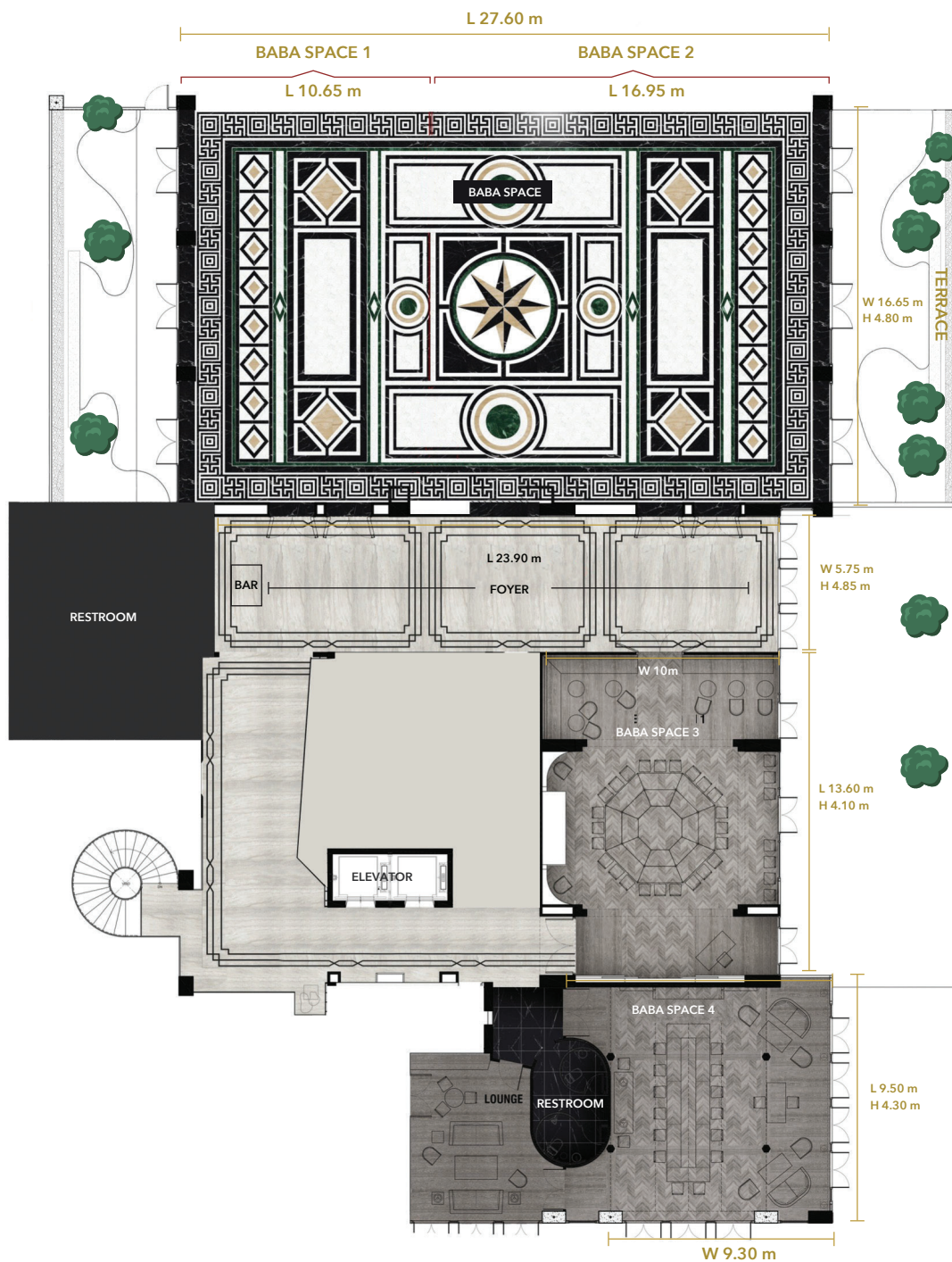

Event Space	Dimensions (LxWxH) m.	Area (sq. m)	Capacity (Persons)					
			Theatre	Classroom	Hollow Square	U-Shape	Reception/Cocktail	Banquet
1 Baba Space	27.60 x 16.65 x 4.8	459.54	400	230	-	-	420	210
2 Baba Space 1	10.65 x 16.65 x 4.8	177.32	160	60	-	42	170	54
3 Baba Space 2	16.95 x 16.65 x 4.8	282.2	210	120	-	-	250	100
4 Baba Space 3	13.60 x 10 x 4.10	136	64	30	24	30	45	45
5 Baba Space 4	9.50 x 9.30 x 4.30	88.35	42	30	-	24	55	28
6 Foyer	23.90 x 5.75 x 4.85	137.43	-	-	-	-	-	-
7 Baan Chok - Outdoor lawn	50 x 30	1,500	-	-	-	-	300	200
8 Baan Chok - Indoor	14.1 x 8.3 x 2.8	117.03	120	60	-	-	120	60
9 Baan Chok - Meeting Room	8.5 x 5.6 x 2.6	47.6	-	-	-	20	-	-
10 Baan Chok - Reading Room	8.0 x 5.4 x 2.5	43.2	48	24	-	24	-	-

